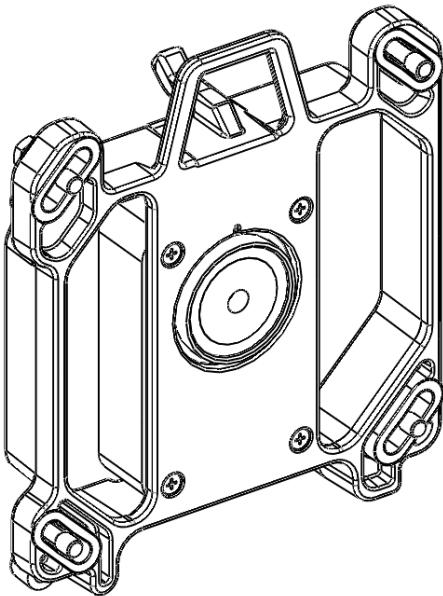

PTP820 C/S and RFU-C to Dragonwave Antenna Interface – Installation Instructions

This guide explains how to mount PTP820 mediation devices on Dragonwave antennas.

List of Kits

Item	Description	Quantity	Remarks
1	PTP820 C/S and RFU-C to Dragonwave Antenna adaptor	1	
2	RFU-C or PTP820C OMT	1	

Mediation devices:



PTP820C OMT

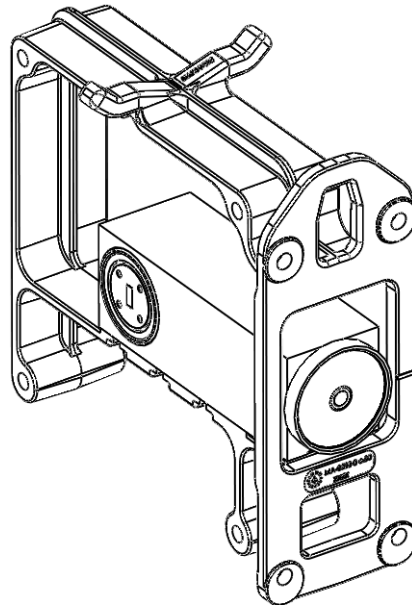

RFU-C OMT

Required tools

- Metric offset hexagon key wrench #6
- Metric wrench 13 mm

Procedure

- 1 Carefully clean and grease the O-ring mounted on the Dragonwave antenna using the grease tube supplied in the PTP820C/S and RFU-C Dragonwave antenna adaptor kit box.

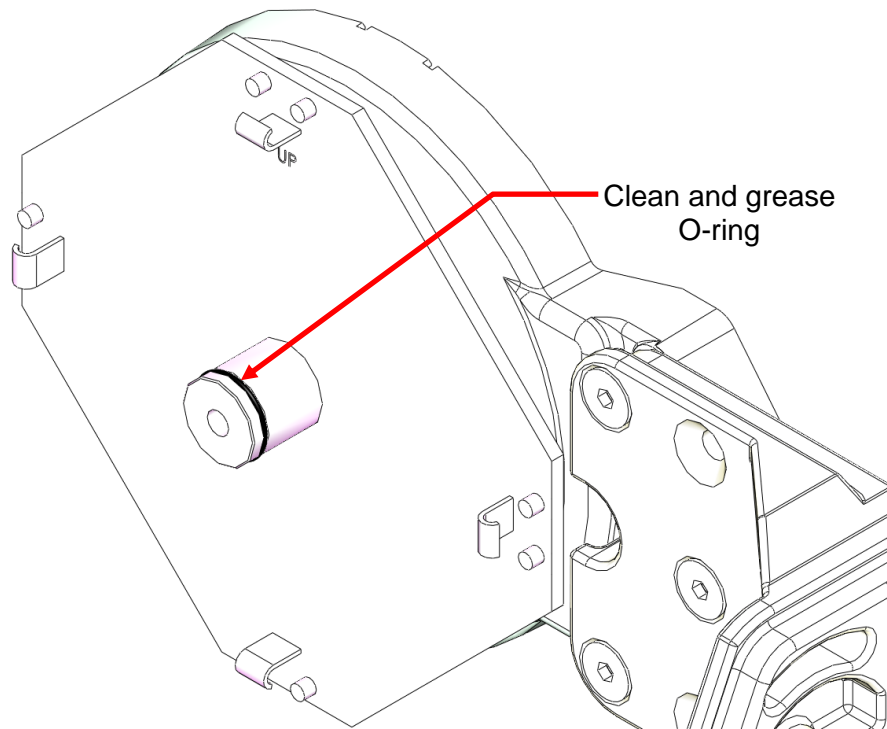

- 2 Gently slide the PTP820C/S and RFU-C Dragonwave antenna adaptor onto the Dragonwave antenna. Make sure that the hook is facing up and close the latches firmly.
- 3 If the O-ring is already mounted to the PTP820C/S and RFU-C side of the Dragonwave antenna adaptor, just remove gently the adhesive tape. If the O-ring is not mounted, place the O-Ring supplied in the RFU-C Dragonwave Interface kit onto the PTP820C/S and RFU-C Dragonwave interface. Make sure the mounting direction is correct, as shown in the section view.

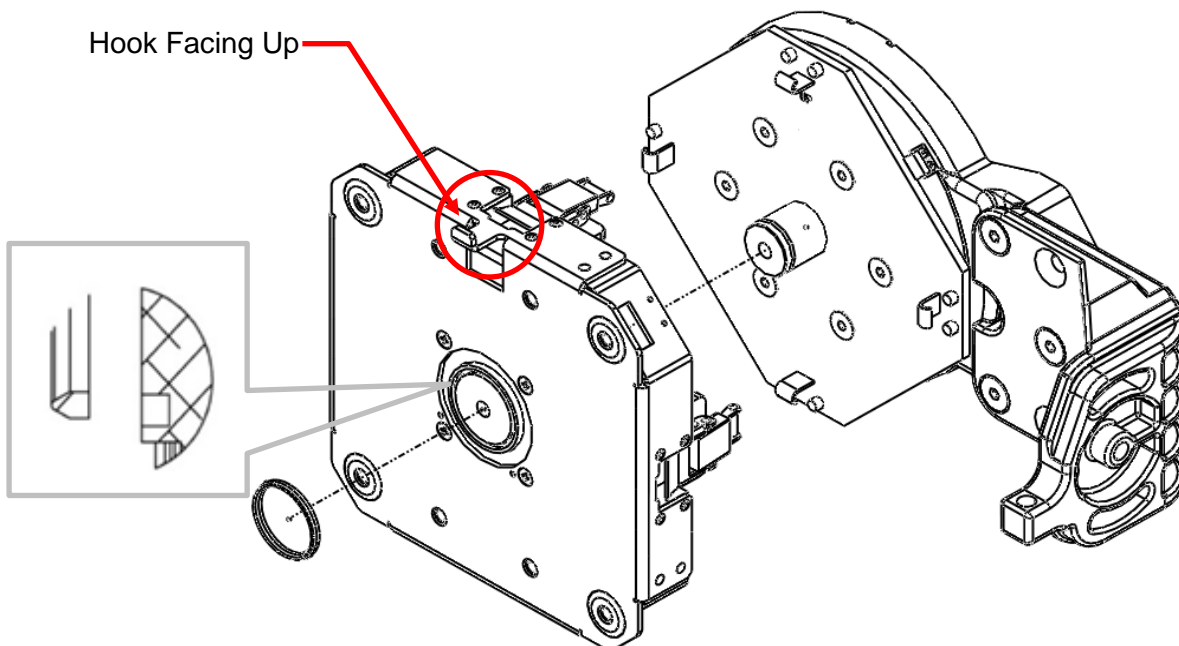

-
- 4 Mount the OMT onto the PTP820C/S and RFU-C Dragonwave antenna adaptor using the screws provided in the OMT kit.

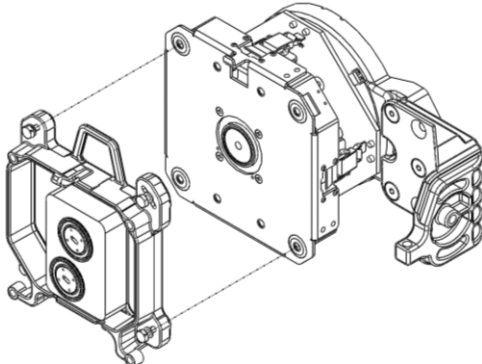

PTP820C OMT

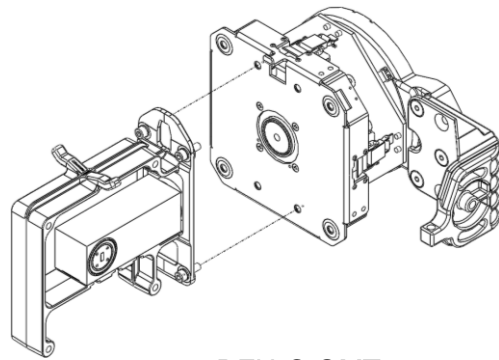

RFU-C OMT

- 5 Mount the Radio according to the relevant radio installation instructions.