



**Cambium Networks™**

## PTP 820 REMEC Adaptor Installation Guide

This guide explains how to installation PTP820 REMEC adaptors:

N060082L217A	PTP820 REMEC interface Antenna Adaptor Kit, 6 GHz, Single Pol
N110082L125A	PTP820 REMEC interface Antenna Adaptor Kit, 11 GHz, Single Pol
N180082L062A	PTP820 REMEC interface Antenna Adaptor Kit, 18 GHz, Single Pol
N110082L126A	PTP820 REMEC interface Antenna Adaptor Kit, 11 GHz, Dual Pol
N180082L063A	PTP820 REMEC interface Antenna Adaptor Kit, 18 GHz, Dual Pol
N230082L070A	PTP820 REMEC interface Antenna Adaptor Kit, 23 GHz, Dual Pol

Exhibition A – Installation of REMEC Interface antenna adaptor kit – Single Pol

Exhibition B – Installation of REMEC Interface antenna adaptor kit – Dual Pol

# Exhibition A – Installation of REMEC Interface antenna adaptor kit – Single Pol

This guide explains the process for installing an PTP 820C, PTP820S, or RFU-C unit to an antenna using following adaptors:

N060082L217A	PTP820 REMEC interface Antenna Adaptor Kit, 6 GHz, Single Pol
N110082L125A	PTP820 REMEC interface Antenna Adaptor Kit, 11 GHz, Single Pol
N180082L062A	PTP820 REMEC interface Antenna Adaptor Kit, 18 GHz, Single Pol

## Installation options are:

- Direct Mount (1 x PTP 820S or 1 x RFU-C)
- Coupler (2 x PTP 820S or 2 x RFU-C)
- Splitter (1 x PTP 820C)

## Required tools

- Metric offset hexagon key wrench #6
- Metric offset hexagon key wrench #3
- Screwdriver Phillips #2

## Procedure

1. Prior to the installation, check the polarization definition on the antenna. Also check that the O-Ring of the antenna is mounted properly.
2. By default, the REMEC Tube is mounted with vertical polarization. If necessary, switch the polarization by releasing four countersink screws, rotating the central adaptor 90 degrees, and re-tightening the screws.

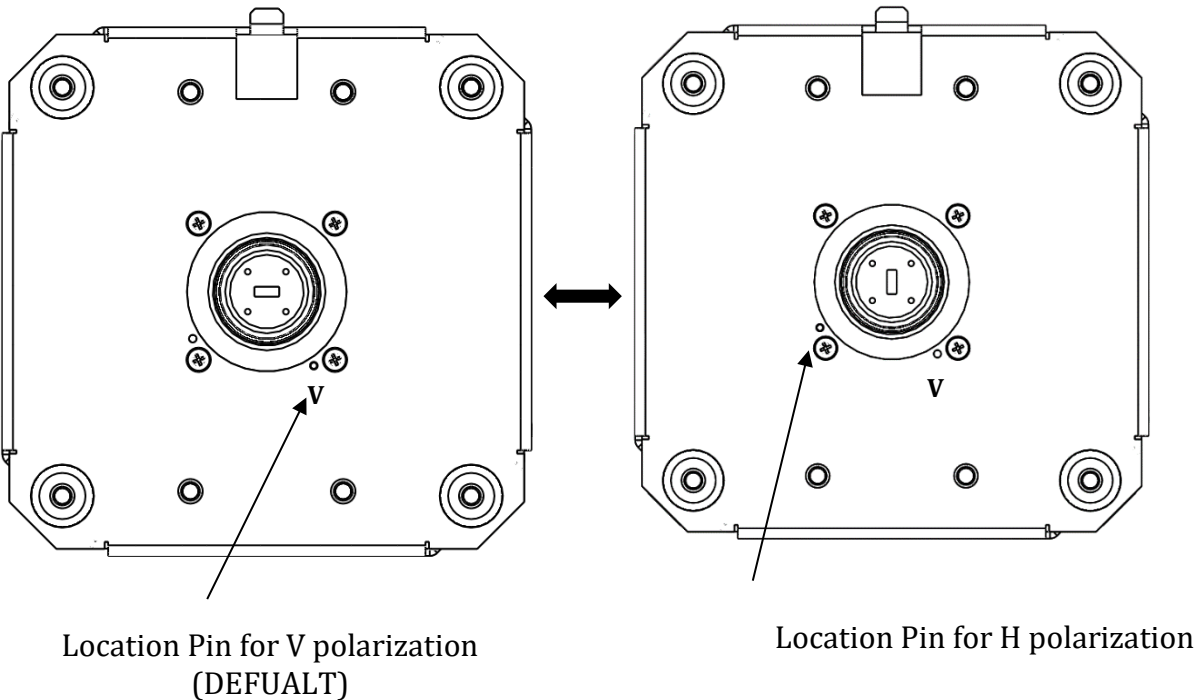

3. Mount the O-Ring supplied in the PTP 820S/RFU-C REMEC Adaptor kit for single polo on the appropriate place on the Tube. Make sure the mounting direction is correct, as shown in the section view.

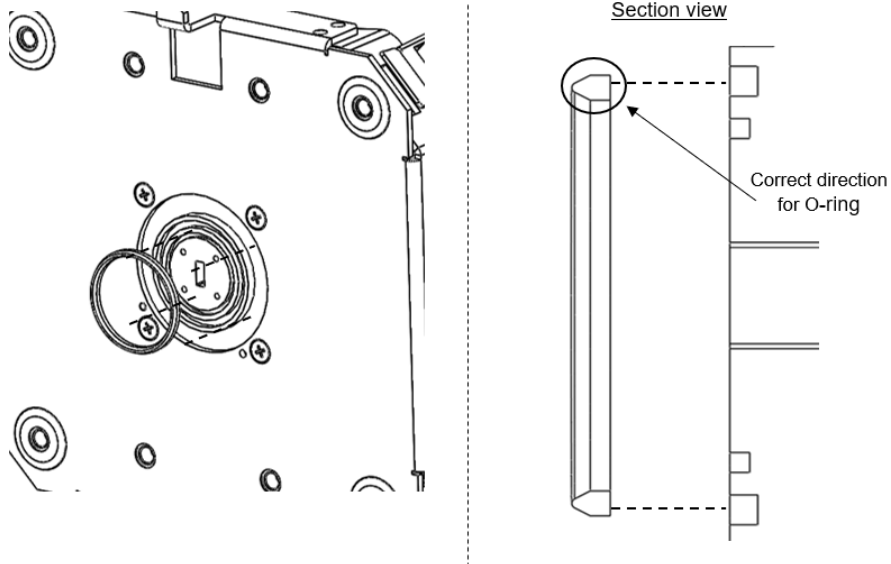

4. Locate and match the ADAPTOR to the antenna interface.

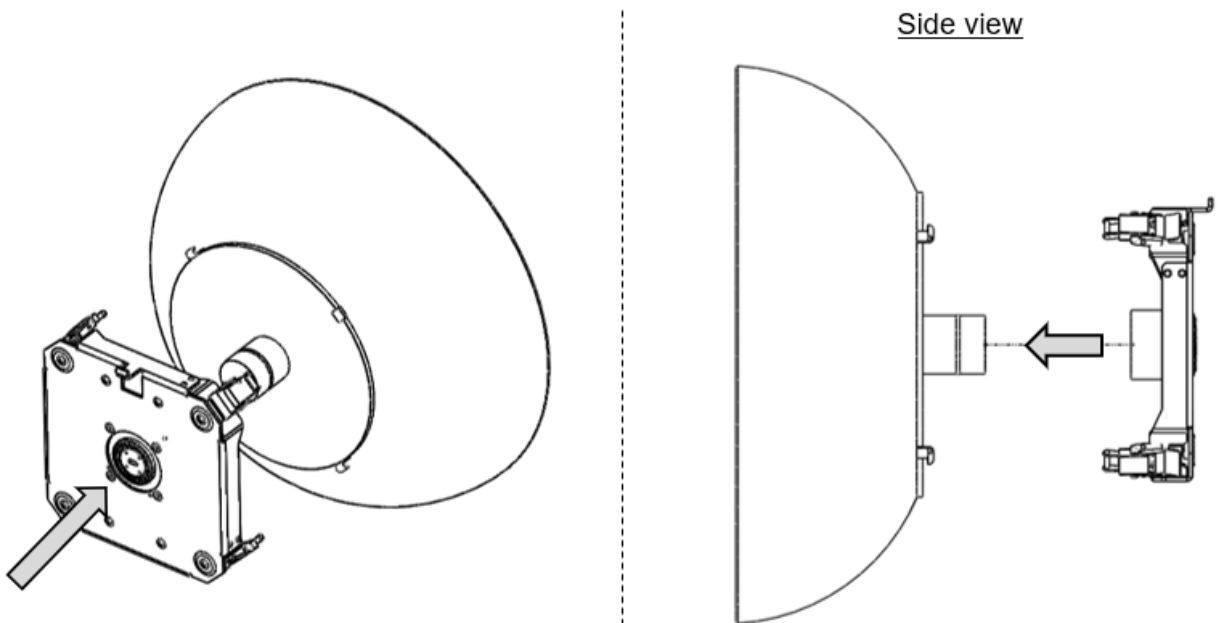

5. Lock the four latches

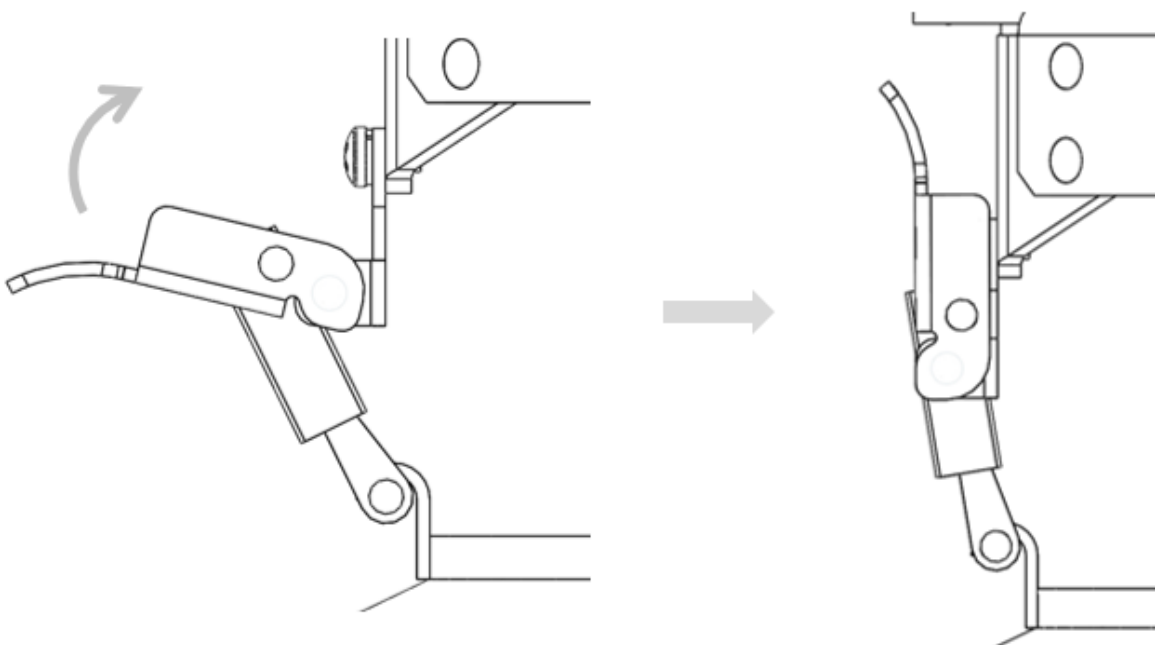

## For PTP820S/RFU-C Direct Mount

**Important!** Do not remove the transparent pressure window located on the antenna interface.

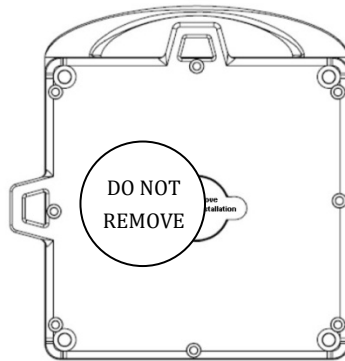

- 1 Mount the PTP 820S/RFU-C to the REMEC Adaptor, using the four M8 captive screws and washers supplied with the PTP 820S or RFU-C kit, and tighten the screws.

Note: PTP 820S/RFU-C mounting screws and washers can be supplied either assembled on the PTP 820S or RFU-C, or as a part of the PT 820S or RFU-C kit.

Make sure the radio polarization mounting direction is correct.

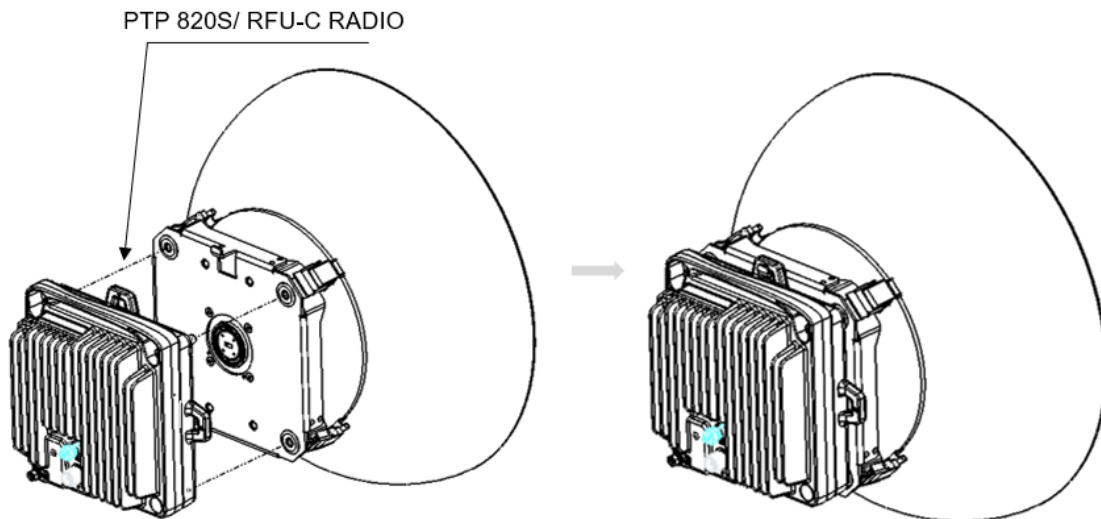

**For PTP820S/RFU-C 1+1 Mounting with coupler:**

**Important!** Do not remove the transparent pressure window located on the antenna interface.

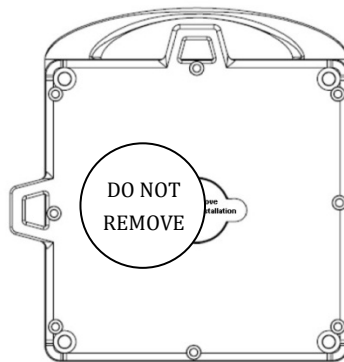

- 1 Mount the two O-Rings supplied in the Coupler kit and twist on the Coupler body, as defined in the Coupler kit instructions.
- 2 Mount the coupler on the PTP 820S/RFU-C REMEC Adaptor using the four M8 screws and washers supplied in the Coupler kit, and tighten the screws.

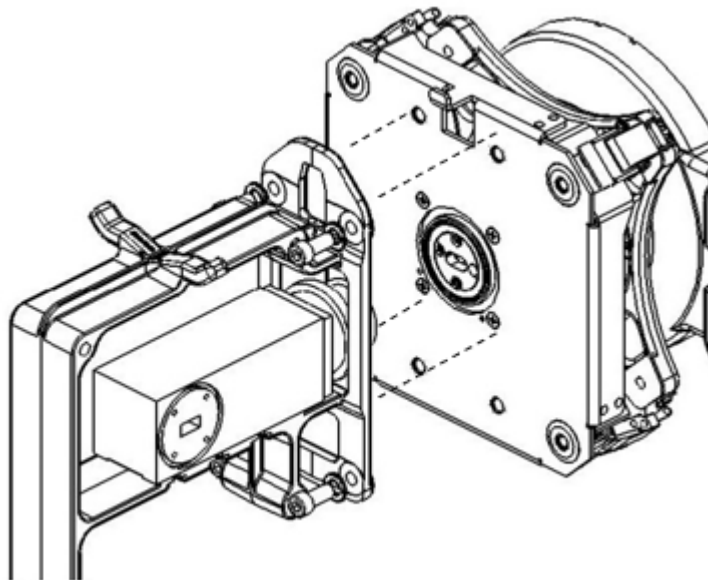

- 3 Proceed with mounting the RFU-C or PTP 820S radios, as defined in the Coupler kit instructions.

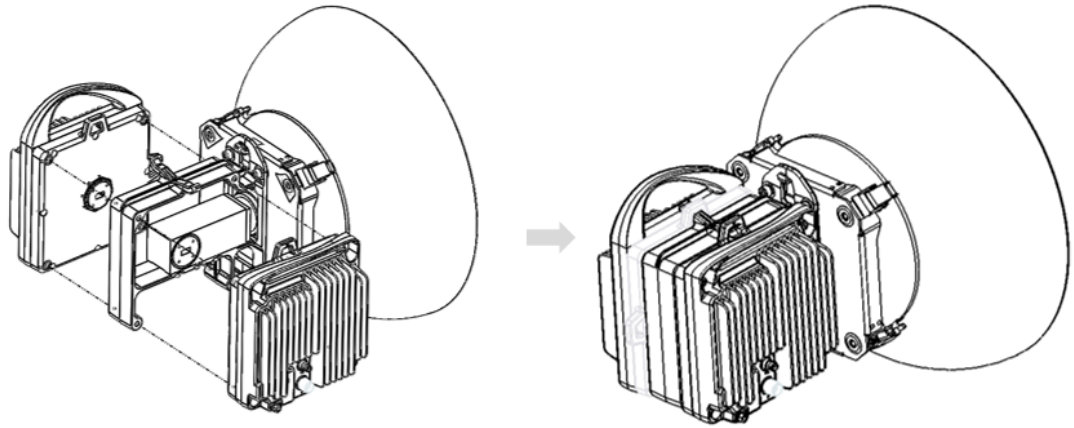



**For PTP820C Mounting with splitter:**

1. Mount the PTP 820C Splitter on the Adaptor, using the 4 M8 captive screws and washers supplied with the PTP 820C Splitter kit, and tighten the screws.

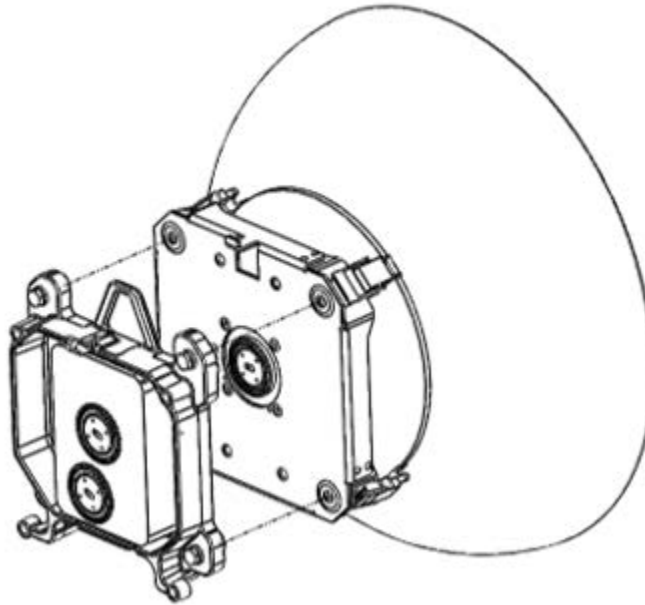

2. Proceed with mounting the IP-20C Radio, as described in the Splitter kit instructions

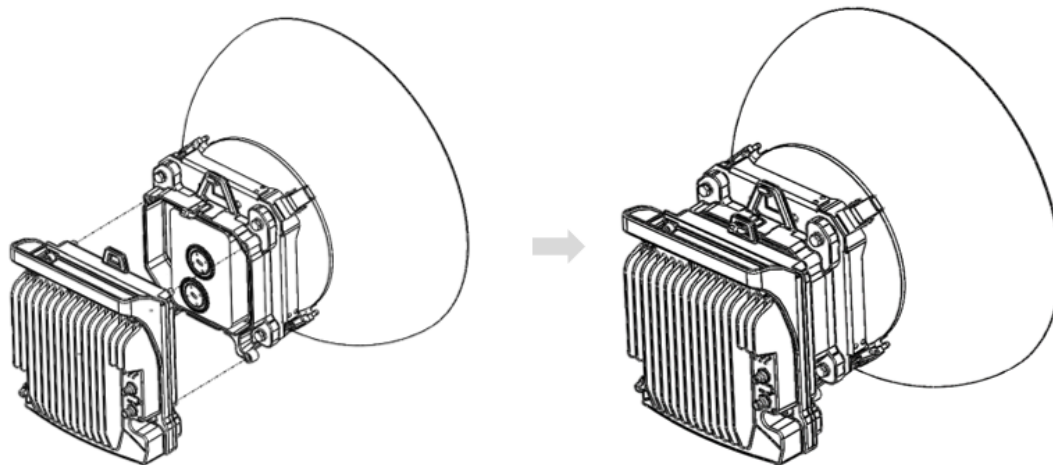

**Important!** For the warranty to be honored, install the unit in accordance with the instructions above.

# Exhibition B – Installation of REMEC Interface Adaptor with Circular Tube

This guide explains the process for installing an PTP 820C, PTP820S, or RFU-C unit to an antenna using following adaptors:

N110082L126A	PTP820 REMEC interface Antenna Adaptor Kit, 11 GHz, Dual Pol
N180082L063A	PTP820 REMEC interface Antenna Adaptor Kit, 18 GHz, Dual Pol
N230082L070A	PTP820 REMEC interface Antenna Adaptor Kit, 23 GHz, Dual Pol

## Installation options are:

- OMT (2 x PTP 820S or 2 x RFU-C)
- OMT (1 x PTP 820C)

## Required tools

- Metric offset hexagon key wrench #6
- Metric offset hexagon key wrench #3
- Screwdriver Phillips #2

## Procedure

1. Mount the O-Ring supplied in the PTP 820SS/ RFU-C REMEC ADAPTOR KIT on the REMEC Tube. Make sure the mounting direction is correct, as shown in the section view

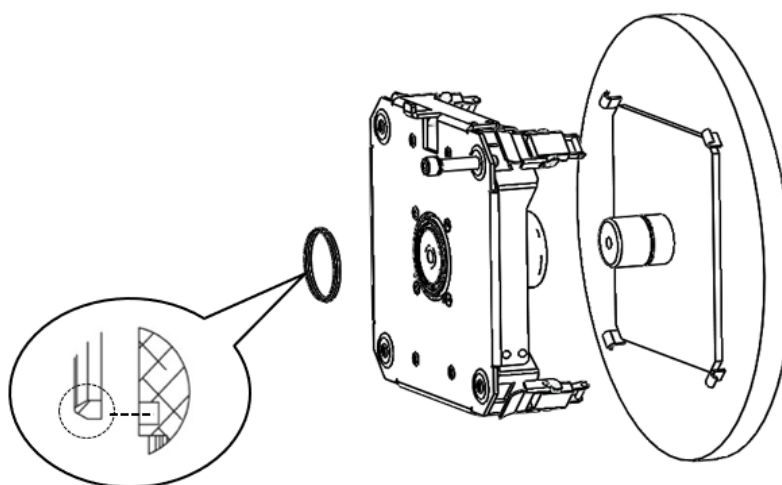

**For PTP820S/RFU-C or PTP820C 2+0 Mounting with OMT:**

**Important!** Do not remove the transparent pressure window located on the antenna interface.

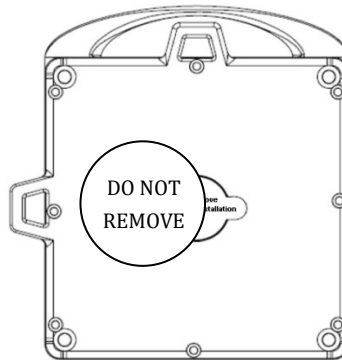

- 1 Mount the OMT on the REMEC adaptor using the four M8 screws and washers supplied in OMT kit and tighten the screws.
- 2 Proceed with mounting the PTP 820S/RFU-C or PTP820C as defined in the OMT kit instructions.

PTP820S/RFU-C Configuration

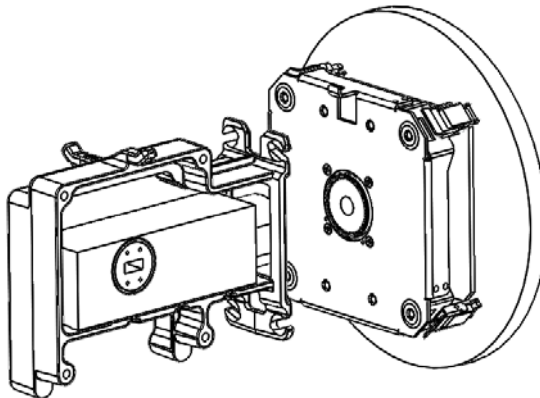

PTP820C Configuration

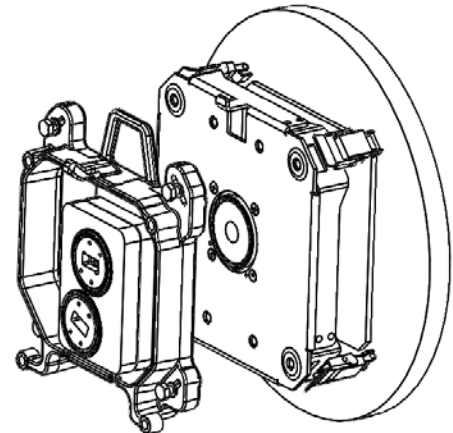

or

**Important!** For the warranty to be honored, install the unit in accordance with the instructions above.